

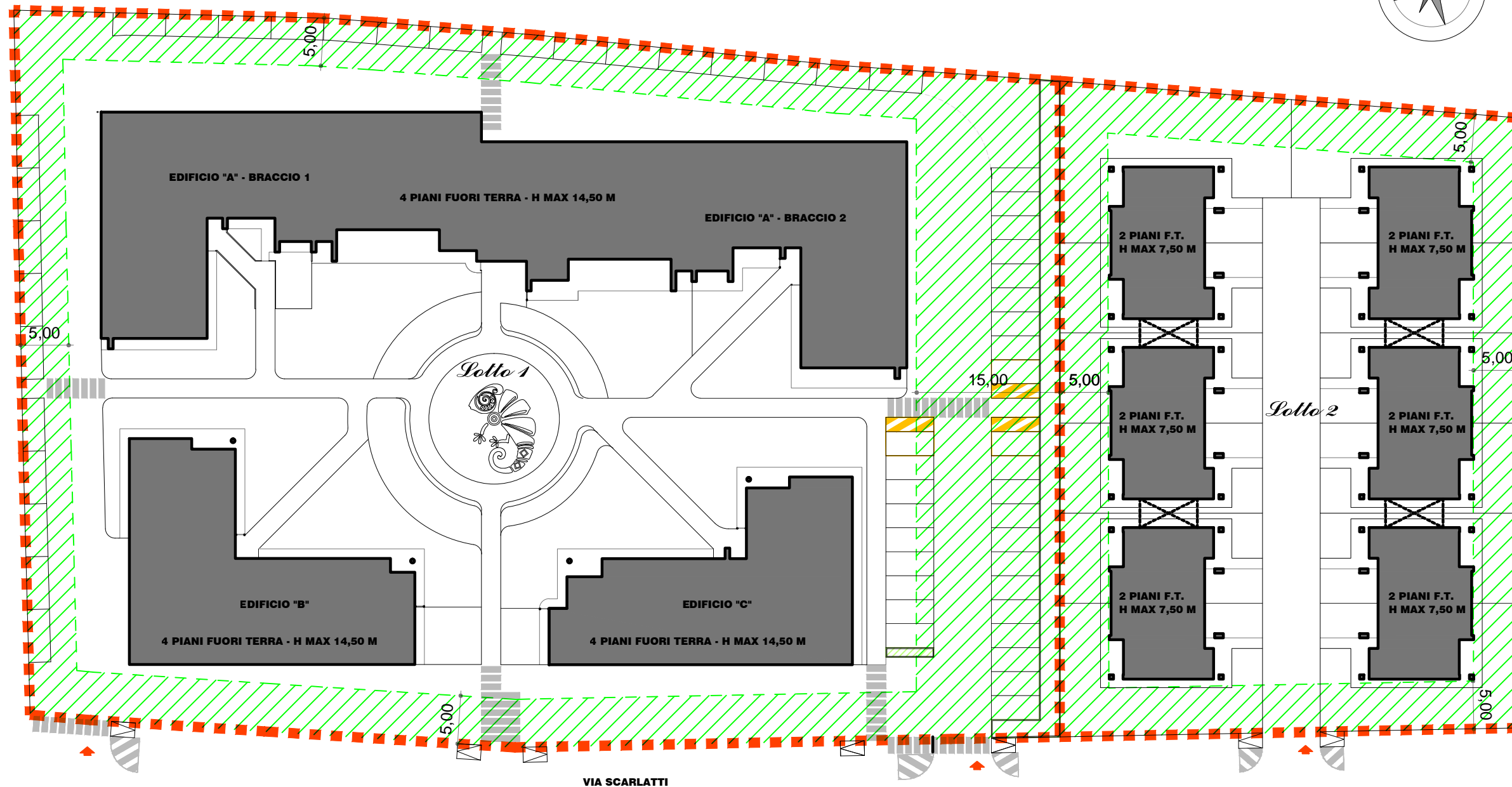

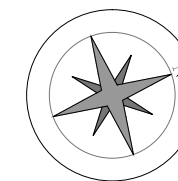

# COMPARTO Cm.1 VIA SCARLATTI

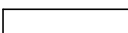

## LEGENDA

-  DISTANZE MINIME FABBRICATI DAI CONFINI DI PROPRIETA', DI ZONA E TRA LOTTI
-  AREA DI MASSIMO INGOMBRO DEI FABBRICATI
-  SEDIME DEGLI EDIFICI DI PROGETTO (NON VINCOLANTE)
-  CONFINI DI COMPARTO E DEI LOTTI

SUPERFICIE FONDIARIA TOTALE INTERO COMPARTO = 11.132 MQ

SUPERFICIE FONDIARIA LOTTO 1 = 7.853 MQ

SUPERFICIE FONDIARIA LOTTO 2 = 3.279 MQ

MASSIMA SUPERFICIE UTILE LOTTO 1 = 4.727,91 MQ

MASSIMA SUPERFICIE ACCESSORIA LOTTO 1 = 3.175,39 MQ

MASSIMA SUPERFICIE UTILE LOTTO 2 = 1.140,00 MQ